

tweak Enhance
Rechargeable Hearing Amplifier

box contents

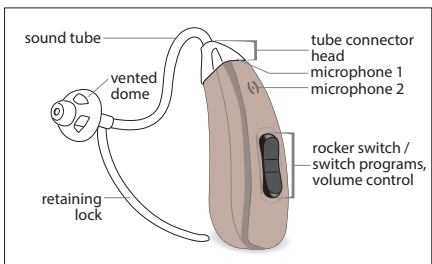
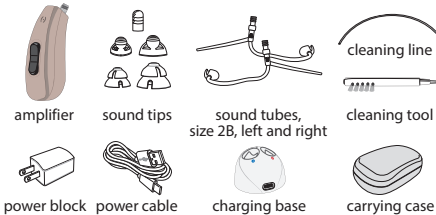

charging information

- 1 Plug the type-C USB connector into the charging base.
- 2 Plug the opposite end of the cable into adapter block then connect with power source.



green light on base—normal operation

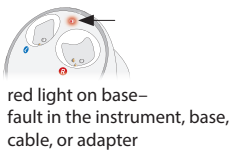

red light on base—fault in the instrument, base, cable, or adapter

Call 1-888-815-3240 for assistance.



- 3 The charging base is marked with blue and red circles. Place amplifier in the corresponding port. It will shut off automatically when placed in the charger.

The rocker switch will glow blue while charging. When fully charged, the rocker switch will glow green.

Fully charge Tweak Enhance before proceeding to setup.

preparing for use

- 1 Choose either a left or right sound tube.
- 2 Attach tube connector end to sound post on amplifier. Twist tube clockwise until snug.
- 3 Choose tip to use with sound tube.
- 4 Align tip with end of sound tube and push tip straight on.

wearing tweak enhance

- 1 Place Tweak Enhance over your ear. The curve of the sound tube should rest on top of your ear comfortably, even with glasses.
- 2 Grab the loose end of the tubing and gently insert the tip into the ear canal.
- 3 Position the retaining lock in the bowl of the ear.
- 4 When properly inserted, the tubing will lay close to the head around the front of the ear and into the ear canal. Check this by moving your finger down the tubing, into the ear.

Now you are ready to install the Tweak Enhance app on your phone and set up your devices.

SCAN ME

Refer to the APP GUIDE inside the user manual to set up the Enhance devices using the Tweak Enhance app. App can be downloaded at the App Store or Google Play Store. Scan the QR card at left for a shortcut to accessing the app.

using tweak enhance

Turning ON and OFF

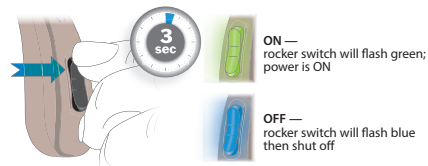

To turn ON or OFF, press and hold the **upper portion** of the rocker switch until you hear a beep (approx. 3 seconds) then release. While you are holding the rocker switch, it will turn green. The green light will turn off once the amplifier is ON.

To turn OFF, press and hold the **upper portion** of the rocker switch until you hear a beep (approx. 3 seconds) then release. While you are holding the rocker switch, it will turn blue. The blue light will turn off once the amplifier is OFF.

Volume Control

The rocker switch is used as a volume control. Pressing the upper portion increases the volume, while the lower portion reduces the volume.

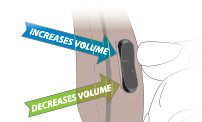

As you increase/decrease the volume, you will hear beep sounds for each sound level.

Level 1	Level 2	Level 3	Level 4 MAX Volume
Beep	Beep	Beep	2 Beeps

Level 1	Level 2	Level 3	Level 4 MAX Volume
Beep	Beep	Beep	2 Beeps

Memory Switch

When the hearing instrument is turned ON, it will revert to the last program and volume setting.

To switch programs, press and hold the **lower portion** of the rocker switch for two seconds then release. Do the same to switch to the other programs.

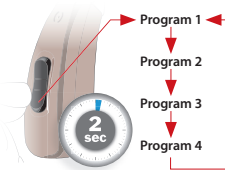

Program	Suitable for	Indicator
1	Conversation	1 Beep
2	Restaurant	2 Beeps
3	Traffic	3 Beeps
4	Outdoor	4 Beeps