

tweakdry^{uv}

WHAT'S INCLUDED

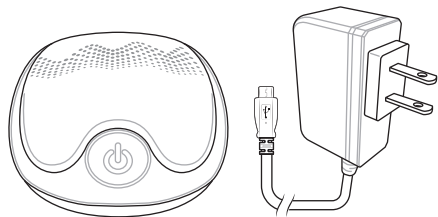

PREPARING FOR USE

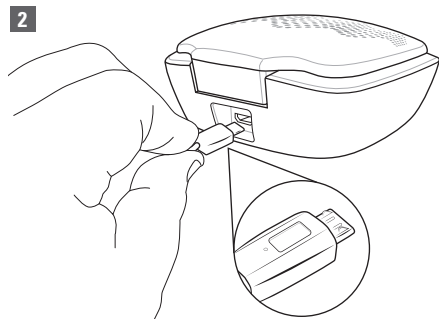
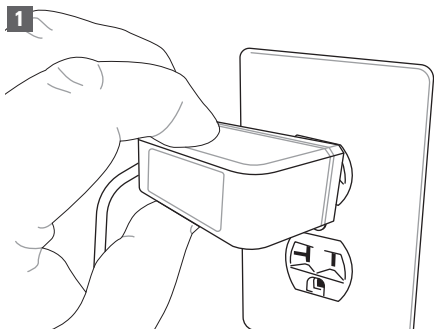

DAILY USE

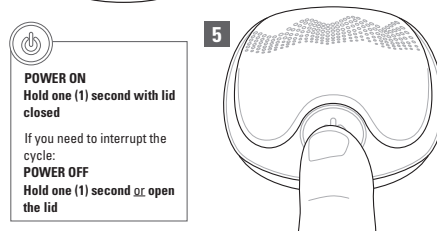
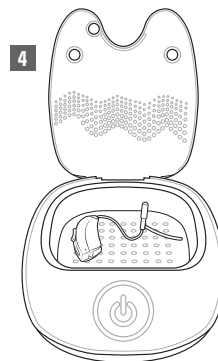
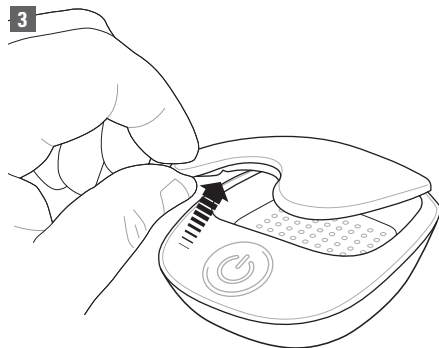

POWER ON

Hold one (1) second with lid closed

If you need to interrupt the cycle:

POWER OFF

Hold one (1) second \square open the lid

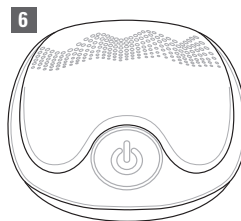

IMPORTANT SAFETY INFORMATION

This product is for household use. When using electrical products, especially when children are present, basic safety precautions should always be followed, including:

DANGER

–To reduce the risk of electrocution:

- Do not use while bathing.
- Do not place or store product where it can fall or be pulled into a tub or sink.
- Do not place in or drop into water or other liquid
- Do not reach for this device if it has fallen into water. Unplug immediately.

WARNING –To reduce the risk of burns, electrocution, fire, or injury to persons:

- Closely supervise use by, on or near children or invalids.
- Use this product only for its intended use as described in this guide.
- Never operate this product if it has a damaged cord or plug, if it is not working properly, if it has been dropped or damaged, or dropped into water. Return it to the place of purchase or service center for examination and repair.
- Never place the product on a soft surface such as a bed. Keep any air openings free of lint, hair, and the like.
- Do not use outdoors or operate where aerosol (spray) products are being used or where oxygen is being administered.
- The AC adapter included with your unit is made specifically for this product. Do not use it with another appliance, and do not use an adapter from any other electrical device in its place.

NOTE: This product is not designed to diagnose, prevent, monitor, treat, or alleviate disease.

OPERATING CONDITIONS

At an ambient temperature of 70°F (21°C) the operating temperature of this appliance is 107-113°F (42-45°C).

UV-C lamp will shut off if lid is opened during the UV-C cycle. The lamp also shuts off at the end of the 5 minute cycle time.

If the UV-C dryer is not used for long periods of time, the lamp may not light immediately. Simply restart the unit.

tweakdryuv.

P.O. Box 1516 Johnson City, TN 37605 USA
eartech.com | 1-888-327-1299 | info@eartech.com

©ETC TW DRY UV QSG 0321 Rev B

tweakdryuv.

UV-C Convection Dryer

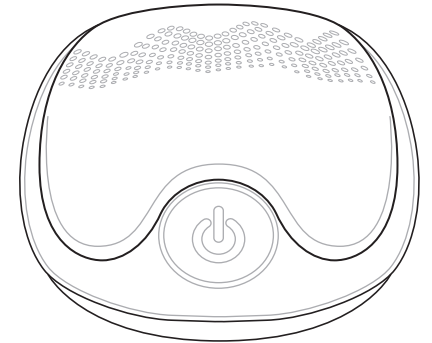

Quick Start Guide



EAR TECHNOLOGY CORPORATION®
Helping people hear better, every day.™